

## Accessori Accessories

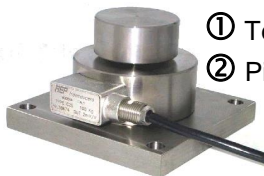

- ① Testa di carico / Loading head
- ② Piastra base / Mounting plate



- ③ Unità di pesatura  
Weighing unit

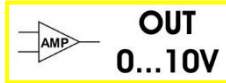
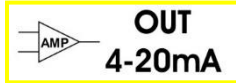
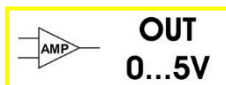
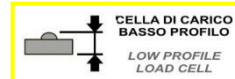

## Dimensioni Dimensions

[mm]



| LOAD                | A  | B  | C  | ØD  | ØE | ØF  | ØG   | H   | I   | M   | n°M | R   | ØS  | T   | U  |
|---------------------|----|----|----|-----|----|-----|------|-----|-----|-----|-----|-----|-----|-----|----|
| from 100 kg to 10 t | 32 | 12 | 11 | 82  | 22 | 68  | 52.3 | 44  | 102 | M8  | 3   | 50  | 60  | 0.3 | 6  |
| 20 t - 30 t         | 50 | 14 | 12 | 126 | 35 | 90  | 77.3 | 64  | 148 | M8  | 3   | 160 | 93  | 0.5 | 15 |
| 50 t - 75 t - 100 t | 60 | 20 | 20 | 165 | 60 | 130 | 92.3 | 80  | 188 | M16 | 4   | 300 | 115 | 1   | 17 |
| 150 t - 200 t       | 80 | 30 | 20 | 200 | 80 | 152 | 107  | 110 | 223 | M16 | 4   | 300 | 128 | 1   | 23 |

| LOAD   | CODE           |
|--------|----------------|
| 100 kg | CC2S82100KC15  |
| 250 kg | CC2S82250KC15  |
| 500 kg | CC2S82500KC15  |
| 1 t    | CC2S821TC15    |
| 2.5 t  | CC2S822T5C15   |
| 5 t    | CC2S825TC15    |
| 7.5 t  | CC2S827T5C15   |
| 10 t   | CC2S8210TC15   |
| 20 t   | CC2S12620TC15H |
| 30 t   | CC2S12630TC15H |
| 50 t   | CC2S16550TC15  |
| 75 t   | CC2S16575TC15  |
| 100 t  | CC2S165100TC15 |
| 150 t  | CC2S200150TC15 |
| 200 t  | CC2S200200TC15 |

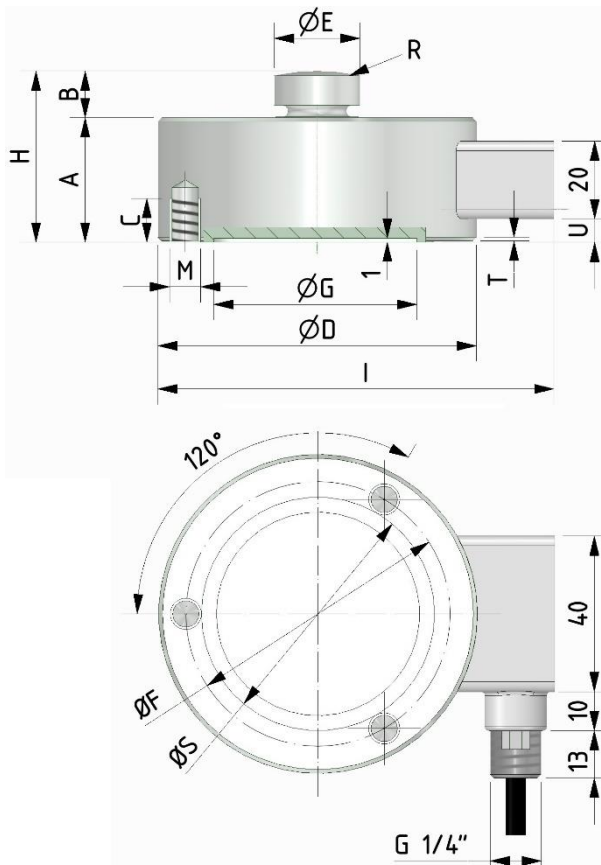

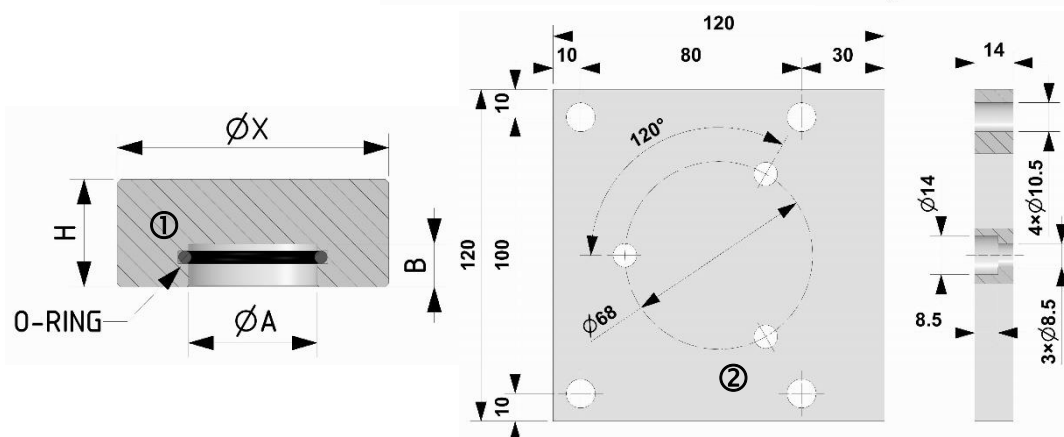
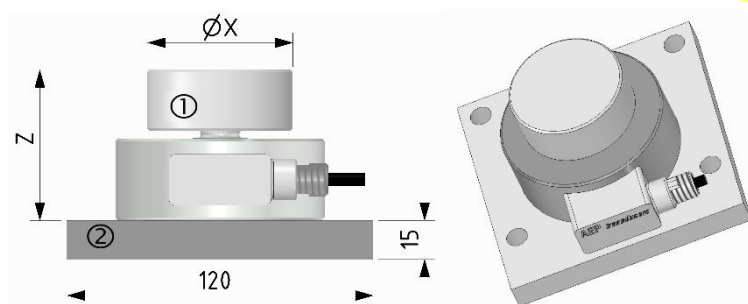

| C2S                                      | CODE      |   | ACCESSORIES    | ACCESSORI         | Z   | ØX  | ØA | B  | H  |
|--|-----------|---|----------------|-------------------|-----|-----|----|----|----|
| 100, 250, 500 kg<br>1, 2.5, 5, 7.5, 10 t | CTIC22    | ① | Loading head   | Testa di carico   | 59  | 57  | 23 | 9  | 24 |
|  | CPB120D82 | ② | Mounting plate | Piastra base      | /   | /   | /  | /  | /  |
|  | CUPC2     | ③ | Weighing unit  | Unità di pesatura | /   | /   | /  | /  | /  |
| 20, 30 t                                 | CTIC35    | ① | Loading head   | Testa di carico   | 82  | 76  | 36 | 12 | 30 |
|  | CUPC3     | ③ | Weighing unit  | Unità di pesatura | /   | /   | /  | /  | /  |
| 50, 75, 100 t                            | CTIC60    | ① | Loading head   | Testa di carico   | 106 | 126 | 61 | 12 | 38 |
|  | CUPC5     | ③ | Weighing unit  | Unità di pesatura | /   | /   | /  | /  | /  |
| 150, 200 t                               | CTIC80    | ① | Loading head   | Testa di carico   | 157 | 128 | 81 | 21 | 68 |

Esempi d'installazione

Examples of installation

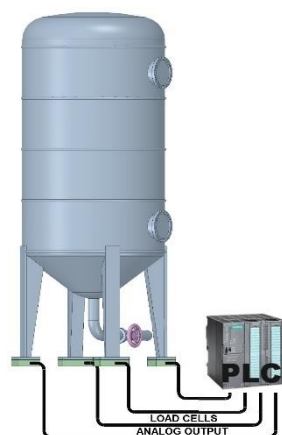
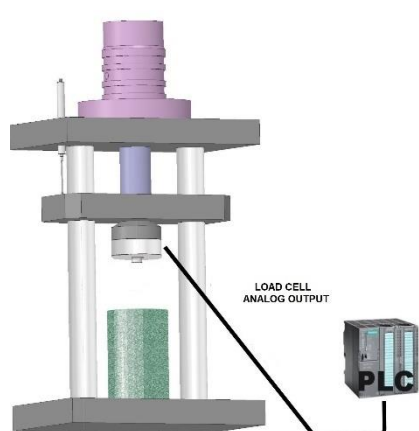

③ Unità di pesatura / Weighing unit

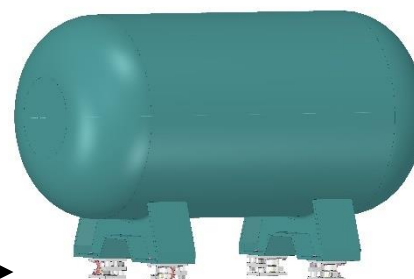
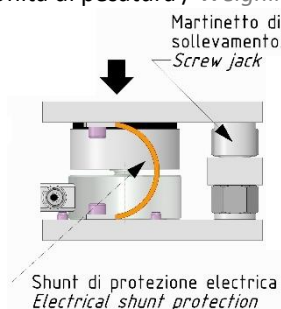

Sistema di pesatura serbatoio a 4 punti di appoggio  
Weighing system for tank with 4 supporting points.

**Dati Tecnici**
**Technical Data**

|   |   |   |                     |                       |                       |
|---|---|---|---------------------|-----------------------|-----------------------|
| ACCURATEZZA   | ACCURACY  | <b>0.03 %</b>   |                     |                       |                       |
| CARICO NOMINALE ( $E_{max}$ )   | NOMINAL LOAD ( $E_{max}$ )  | 100 – 250 – 500 kg<br>1 – 2.5 – 5 – 7.5 – 10 – 20 t<br>30 – 50 – 75 – 100 – 150 – 200 t   |                     |                       |                       |
| SENSIBILITA' NOMINALE<br>TOLLERANZA DI CALIBRAZIONE   | NOMINAL SENSITIVITY<br>CALIBRATION TOLERANCE  | <b>4-20 mA</b> (3 wires), <b>0...5 V</b> or <b>0...10 V</b><br>< ± 0.1 %                  |                     |                       |                       |
| NON LINEARITA'<br>NON RIPETIBILITA'   | NON LINEARITY<br>NON REPEATABILITY  | ≤ ± 0.03 %<br>≤ ± 0.01 %  |                     |                       |                       |
| EFFETTO DELLA TEMPERATURA (10 °C)<br>a) sullo zero<br>b) sulla sensibilità  | TEMPERATURE EFFECT (10 °C)<br>a) on zero<br>b) on sensitivity   | ≤ ± 0.024 %<br>≤ ± 0.017 %  |                     |                       |                       |
| ALIMENTAZIONE NOMINALE  | NOMINAL POWER SUPPLY  | 0...5 V ➔ 12 ... 28 Vdc<br>4-20 mA and 0...10 V ➔ 18 ... 28 Vdc                           |                     |                       |                       |
| ALIMENTAZIONE MAX.<br>ASSORBIMENTO MAX. (senza carico applicato):<br>RESISTENZA DI CARICO:<br>a) tensione<br>b) corrente<br>RESISTENZA DI ISOLAMENTO<br>BILANCIAMENTO DI ZERO<br>FREQUENZA DI RISPOSTA      | MAX. POWER SUPPLY<br>MAX. ABSORPTION (without load applied)<br>LOADING RESISTANCE:<br>a) tension<br>b) current<br>INSULATION RESISTANCE<br>ZERO BALANCE<br>RESPONSE FREQUENCY                       | 28 Vdc<br>30 mA<br>min. 3 KΩ<br>from 0 to 470 Ω<br>> 2 GΩ<br>± 1 %<br>~ 1 kHz             |                     |                       |                       |
| VALORI MECCANICI LIMITE riferiti al carico nominale:<br>a) carico minimo<br>b) carico di servizio<br>c) carico limite<br>d) carico di rottura<br>e) massimo carico trasversale<br>f) carico dinamico limite | MECHANICAL LIMIT values referred to nominal load:<br>a) minimum load<br>b) service load<br>c) max permissible load<br>d) breaking load<br>e) max transverse load<br>f) max permissible dynamic load | 0 %<br>120 %<br>150 %<br>>300 %<br>50 %<br>50 %   |                     |                       |                       |
| CARICO NOMINALE   | NOMINAL LOAD  | 100 kg<br>... 10 t  | 20 t<br>30 t        | 50 t<br>100 t         | 150 t<br>200 t        |
| FRECCIA MAX. AL CARICO NOMINALE   | DISPLACEMENT AT NOMINAL LOAD  | ~0.06mm   | ~0.16mm             | ~0.23mm               | ~0.36mm               |
| TEMPERATURA DI RIFERIMENTO<br>CAMPO NOMINALE DI TEMP.<br>TEMPERATURA DI ESERCIZIO<br>TEMPERATURA DI STOCCAGGIO  | REFERENCE TEMPERATURE<br>TEMPERATURE NOMINAL RANGE<br>SERVICE TEMPERATURE<br>STORAGE TEMPERATURE  | +23 °C<br>-10 / +40 °C<br>-20 / +70 °C<br>-20 / +80 °C                                    |                     |                       |                       |
| PESO  | WEIGHT  | ~1.3 kg   | ~3.4 kg             | ~9.4 kg               | ~18.2 kg              |
| CLASSE DI PROTEZIONE (EN 60529)<br>MATERIALE DELLA CELLA<br>LUNGHEZZA CAVO  | PROTECTION CLASS (EN 60529)<br>EXECUTION MATERIAL<br>CABLE LENGTH   | IP68 (100h at 1m water column)<br>Acciaio Inox / Stainless Steel<br>5 m (on request 10 m) |                     |                       |                       |
| VITI DI FISSAGGIO:<br>a) diametro<br>b) classe di resistenza<br>c) coppia di serraggio  | FIXING SCREWS<br>a) diameter<br>b) resistance class<br>c) tightening torque   | M8<br>12.9<br>80 Nm   | M8<br>12.9<br>80 Nm | M16<br>12.9<br>230 Nm | M16<br>12.9<br>230 Nm |

Accelerazione di gravità  $g=9.80434 \text{ m/s}^2$  / Acceleration of gravity  $g=9.80434 \text{ m/s}^2$ .

## OPZIONI

Da acquistare separatamente

## OPTIONS

To be purchased separately

|   | CODE            | <sup>(1)</sup> OPZIONE   | <sup>(1)</sup> OPTION  |
|---|-----------------|--|--|
|  | <b>CMIL6MF</b>  | Uscita diretta connettore <b>MIL6M</b>   | <i>Direct output connector MIL6M</i>   |
|  | <b>CMIL6FV5</b> | CONNETTORE <b>MIL6M</b> femmina 6 poli dritto completo di <b>CAVO</b> PVC schermato lunghezza 5 m. | <i>Female 6 poles straight MIL6M CONNECTOR complete PVC CABLE, shielded, length 5 m.</i> |

|  | CODE              | <sup>(2)</sup> OPZIONE  | <sup>(2)</sup> OPTION   |
|--|-------------------|---|---|
|   | <b>CONNM12MF</b>  | Uscita diretta connettore <b>M12</b>  | <i>Direct output connector M12</i>  |
|  | <b>CONNM12FV5</b> | CONNETTORE <b>M12x1</b> femmina 5 poli dritto completo di <b>CAVO</b> PVC costampato schermato lunghezza 3 m. | <i>Female 5 poles straight M12x1 CONNECTOR complete PVC molded CABLE, shielded, length 3 m.</i> |

## Collegamenti Elettrici *Electrical Connections*

**USCITA STANDARD:** cavo schermato PVC 105°C, Ø 5.2 mm a 4× Ø 0.35mm<sup>2</sup> conduttori stagnati.  
**STANDARD OUTPUT:** PVC 105°C shielded cable, Ø 5.2mm with 4× Ø 0.35mm<sup>2</sup> tinned conductors.

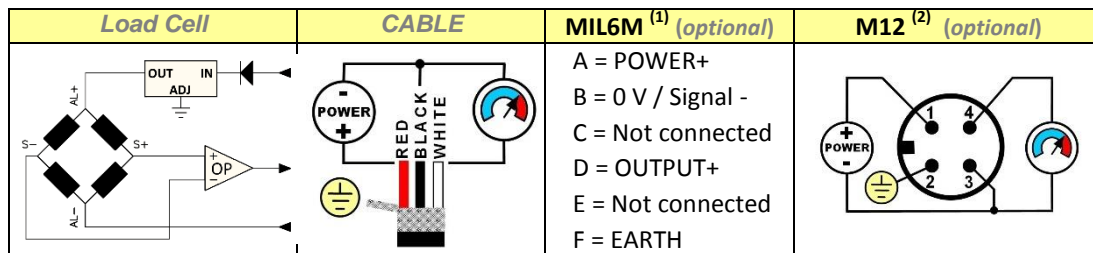

Schermo collegato al corpo del trasduttore.  
*Shield connected to the body of the transducer.*

**AEP** transducers



Dasa-Rägister  
EN ISO 9001:2015  
IQ-1100-01



LAT N° 093  
**Calibration Centre**  
The products are NOT covered by accreditation



**Production Quality Assurance Certified n°**  
TÜV CY 17 ATEX 0205891 Q

41126 Cognento (MODENA) Italy Via Bottego 33/A Tel: +39-(0)59-346441 Fax: +39-(0)59-346437 E-mail: aep@aep.it

Al fine di migliorare le prestazioni tecniche del prodotto, la società si riserva di apportare variazioni senza preavviso.

In order to improve the technical performances of the product, the company reserves the right to make any change without notice.